

# Cam-Operated Couplings

Plastic Cam-Operated Couplings



**ESOP** Employee Owned  
for Your Benefit

Fluid Transfer Specialists®

## Plastic Cam Operated Couplings

### NYLON (Glass Fiber Reinforced)

- High impact strength at much lighter weight than metal counterparts
- Corrosion resistant
- Will not easily cross thread or seize on mating threads
- Electrically non-conductive
- Resistant to most hydrocarbons, solvents, mild acids, and agricultural chemicals
- Made to MIL-C-27487 dimensions — fully interchangeable with other materials made to the same standards

### POLYPROPYLENE (Glass Fiber Reinforced)

- Similar properties to nylon (above) yet more resistant to most acids than nylon couplings
- Made to MIL-C-27487 dimensions

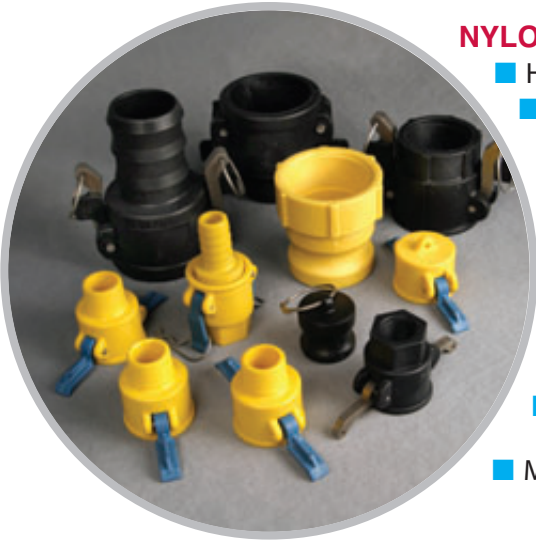

Made in U.S.A.

### Notes

#### NYLON

Material: Glass-fiber reinforced nylon — yellow in color

|                     |                                 |
|---------------------|---------------------------------|
| Standard Gasket:    | EPDM                            |
| Handle:             | 304L Stainless Steel            |
| Pin:                | 302 Stainless Steel             |
| Temperature Range:  | -30°F to 200°F**                |
| Working Pressure**: | 1/2" thru 1"      175 psi       |
|                     | 1-1/4" thru 2"      150 psi     |
|                     | 3"                      100 psi |
|                     | 4"                      50 psi  |

#### POLYPROPYLENE (PP)

Material: Glass-fiber reinforced polypropylene — black in color

|                     |                                |
|---------------------|--------------------------------|
| Standard Gasket:    | EPDM                           |
| Handle:             | 304L Stainless Steel           |
| Pin:                | 302 Stainless Steel            |
| Temperature Range:  | 10°F to 180°F**                |
| Working Pressure**: | 1/2" thru 1"      125 psi      |
|                     | 1-1/4" thru 2"      100 psi    |
|                     | 3"                      75 psi |

CAM OPERATED COUPLINGS are available with BSPT (metric) threads through minimum order.

\*\*Values listed are typical for the material used in manufacture, except where noted, and are meant only as a guide to aid in design. Field testing should be performed to find the actual values for your application. Clamps must be used in higher pressure applications; testing recommended.

## Plastic Cam Operated Couplings

■ Note that sizes are listed first due to the two materials offered.

### Type A – Adapter x FNPT

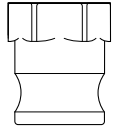

| SIZE (IN.) | PART NO. NYLON | PART NO. PP |
|------------|----------------|-------------|
| 1/2        | 560 0077       | 561 0052    |
| 3/4        | 560 0105       | 561 0080*   |
| 1          | 560 0133       | 561 0108    |
| 1-1/4      | 560 0161*      | 561 0136*   |
| 1-1/2      | 560 0189       | 561 0164    |
| 2          | 560 0217       | 561 0192    |
| 3          | 560 0245       | 561 0220    |
| 4          | 560 0273       |             |

### Type E – Adapter x Hose Barb

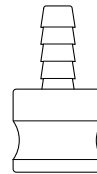

| SIZE (IN.) | PART NO. NYLON | PART NO. PP |
|------------|----------------|-------------|
| 1/2        | 560 1561       | 561 1424    |
| 5/8        | 560 1589       |             |
| 3/4        | 560 1617       | 561 1452    |
| 1          | 560 1645       | 561 1480    |
| 1-1/4      | 560 1673*      | 561 1508*   |
| 1-1/2      | 560 1701       | 561 1536    |
| 2          | 560 1729       | 561 1564    |
| 3          | 560 1757*      | 561 1592*   |
| 4          | 560 1785       |             |

### Type B – Coupler x MNPT

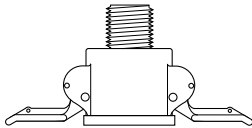

| SIZE (IN.) | PART NO. NYLON | PART NO. PP |
|------------|----------------|-------------|
| 1/2        | 560 0385       | 561 0388    |
| 3/4        | 560 0413       | 561 0416    |
| 1          | 560 0441       | 561 0444    |
| 1-1/4      | 560 0469*      | 561 0472*   |
| 1-1/2      | 560 0497       | 561 0500    |
| 2          | 560 0525       | 561 0528    |
| 3          | 560 0553       | 561 0556    |
| 4          | 560 0581       |             |

### Type F – Adapter x MNPT

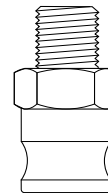

| SIZE (IN.) | PART NO. NYLON | PART NO. PP |
|------------|----------------|-------------|
| 1/2        | 560 1953       | 561 1760    |
| 3/4        | 560 1981       | 561 1788    |
| 1          | 560 2009       | 561 1816    |
| 1-1/4      | 560 2037*      | 561 1844*   |
| 1-1/2      | 560 2065       | 561 1872    |
| 2          | 560 2093       | 561 1900    |
| 3          | 560 2121       | 561 1928    |
| 4          | 560 2149       |             |

### Type C – Coupler x Hose Barb

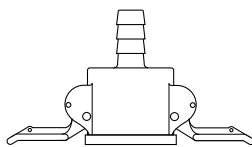

| SIZE (IN.) | PART NO. NYLON | PART NO. PP |
|------------|----------------|-------------|
| 1/2        | 560 0749       | 561 0724    |
| 5/8        | 560 0777       |             |
| 3/4        | 560 0805       | 561 0752    |
| 1          | 560 0833       | 561 0780    |
| 1-1/4      | 560 0861*      | 561 0808*   |
| 1-1/2      | 560 0889       | 561 0836    |
| 2          | 560 0917       | 561 0864    |
| 3          | 560 0945       | 561 0892    |
| 4          | 560 0973       |             |

### Type DP – Plug

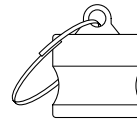

| SIZE (IN.) | PART NO. NYLON | PART NO. PP |
|------------|----------------|-------------|
| 3/4        | 560 2989*      | 561 3160    |
| 1          | 560 3017*      | 561 3188    |
| 1-1/2      | 560 3045*      | 561 3216    |
| 2          | 560 3073*      | 561 3244    |
| 3          | 560 3101*      | 561 3272    |
| 4          | 560 3129*      |             |

### Type D – Coupler x FNPT

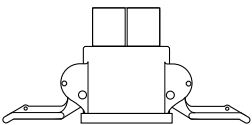

| SIZE (IN.) | PART NO. NYLON | PART NO. PP |
|------------|----------------|-------------|
| 1/2        | 560 1197       | 561 1088    |
| 3/4        | 560 1225       | 561 1116    |
| 1          | 560 1253       | 561 1144    |
| 1-1/4      | 560 1281*      | 561 1172*   |
| 1-1/2      | 560 1309       | 561 1200    |
| 2          | 560 1337       | 561 1228    |
| 3          | 560 1365       | 561 1256    |
| 4          | 560 1393       |             |

### Type DC – Cap

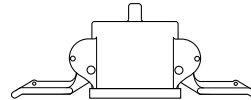

| SIZE (IN.) | PART NO. NYLON | PART NO. PP |
|------------|----------------|-------------|
| 3/4        | 560 2681*      | 561 2488    |
| 1          | 560 2709*      | 561 2516    |
| 1-1/2      | 560 2737*      | 561 2544    |
| 2          | 560 2765*      | 561 2572    |
| 3          | 560 2793*      | 561 2600    |
| 4          | 560 2821*      |             |

On 1/2" and 5/8" sizes, the coupler and adapter portion is made to the 3/4" standard, therefore these sizes will mate together.

On the 1-1/4" size, the coupler and adapter portion is made to the 1-1/2" standard, therefore these sizes will mate together.

\*Limited stock availability; lead times and minimums may apply — call for details.



## Nylobrade® PVC Hose

- Listed by the National Sanitation Foundation for food equipment materials (NSF-51) and potable water (NSF-61)
- Offers far higher pressure capabilities than unreinforced PVC tubing
- Mirror smooth interior permits outstanding flow characteristics
- Corrosion and abrasion resistant with flexibility similar to rubber but with much longer life



## Urebrade® Polyurethane Hose

- Resistant to weathering, tearing, impact, abrasion, radiation exposure, oils, greases and fuels
- Wide range of temperature resistance: -90°F to 175°F
- Free of DEHP, phthalates, BPA and conflict minerals
- Naturally transparent for visual contact with the flow

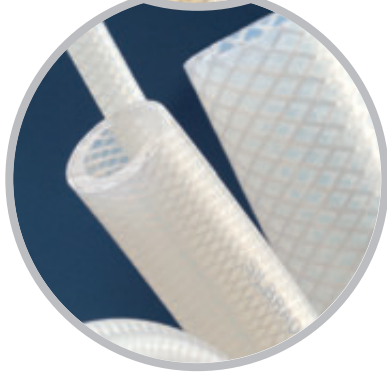

## Silbrade® Silicone Hose

- Odorless, tasteless, and inert
- Excellent weatherability properties — resists U.V., ozone, gases, moisture and extreme temperatures
- Listed by the National Sanitation Foundation (NSF-51) for food equipment materials
- Free of BPA, latex and phthalates; REACH and RoHS compliant

## Request a Fittings & Clamps catalog

Inside you'll find details on all of NewAge Industries' barbed fittings and clamps. Catalogs for PVC, polyurethane, silicone, fluoropolymer, rubber, and semi-rigid tubing and hose are available, as well as push-to-connect fittings and custom products. Contact your NewAge Industries' sales representative or local distributor to request a copy of the catalog you need, or visit [www.newageindustries.com](http://www.newageindustries.com).



Nylobrade®, Urebrade®, Silbrade®, NewAge®, "Fluid Transfer Specialists®," and The "N" Logo are trademarks of NewAge® Industries, Inc.

WARRANTY: NewAge Industries' products are warranted to be free from defects in material and workmanship. Any product found to carry such defects will be replaced without charge. This warranty is limited only to the replacement of NewAge Industries' products, item for item, which after examination by NewAge Industries are deemed defective. NewAge Industries specifically disclaims any other liability. The data supplied is provided as a helpful guideline and is believed to be reliable; however, nothing stated shall constitute a guarantee, recommendation, or warranty for any application.

NOTICE: NewAge Industries, Inc. has been a privately owned corporation since 1954. Neither the corporation nor its principals are affiliated, in any way, with any other group or entity either representing themselves as or being referred to by the term New-Age.

© NewAge Industries, Inc. 2017 Specifications are subject to change without notice.

11/7/17

**DISTRIBUTOR PARTNER**



145 James Way  
Southampton, PA 18966  
[www.newageindustries.com](http://www.newageindustries.com)

800-50-NEWAGE  
(800-506-3924)  
215-526-2300

Fax: 800-837-1856  
215-526-2190

[info@newageindustries.com](mailto:info@newageindustries.com)